

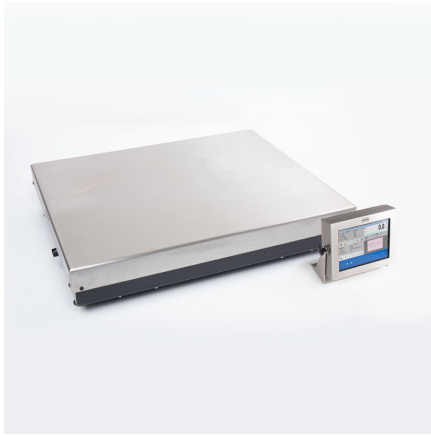

HY10.150.1.HRP.H High Resolution Scale, HY10.1100.HRP.H High Resolution Scale,
HY10.600.HRP.H High Resolution Scale

More information on the website
radwag.com/en/info,w1,0Q1



HY10.150.1.HRP.H High Resolution Scale
HY10.1100.HRP.H High Resolution Scale
HY10.600.HRP.H High Resolution Scale

Functions



Dosing



Labelling



Plus/Minus Control



Percent Weighing



Totalizing



Parts counting



Peak hold



Formulation



Newton unit
measurement



Statistics



Checkweighing



GLP Procedures



Animal weighing



Differential weighing



Replaceable unit



Statistical Quality Control



ALIBI Memory



Transactions

Datasheet

	HY10.150.1.HRP.H High Resolution Scale	HY10.600.HRP.H High Resolution Scale	HY10.1100.HRP.H High Resolution Scale
Metrological parameters			
Maximum capacity [Max]	150 kg	600 kg	1100 kg
Minimum load	50 g	250 g	500 g
Preload range	30 kg	60 kg	100 kg
Readability [d]	1 g	5 g	10 g
Tare range	-150 kg	-600 kg	-1100 kg
Repeatability	1,5 g	7,5 g	15 g
Linearity	±3 g	±15 g	±30 g
Stabilization time	3 s	3 s	3 s
Adjustment	internal (automatic)	internal (automatic)	internal (automatic)
Physical parameters			
Display	10,1" graphic colour touchscreen	10,1" graphic colour touchscreen	10,1" graphic colour touchscreen
Weighing pan dimensions	800×600 mm	1000×800 mm	1000×800 mm
Packaging dimensions	1000×800×307 mm	1200×1000×436 mm	1200×1000×436 mm
Net weight	71,5 kg	126 kg	126 kg
Gross weight	119 kg	160 kg	160 kg
Communication interface			
USB	×2	×2	×2
Ethernet	×1	×1	×1
RS232	×2	×2	×2
Optional add-on modules			
Wi-Fi module (option)	802.11 b/g/n	802.11 b/g/n	802.11 b/g/n
RS485 module (option)	1	1	1
Profibus module (option)	DP SLAVE	DP SLAVE	DP SLAVE
PROFINET module (option)	1 × RJ45	1 × RJ45	1 × RJ45
Analog output module (option)	4-20mA, 0-20mA, 0-10V	4-20mA, 0-20mA, 0-10V	4-20mA, 0-20mA, 0-10V
Inputs/Outputs (option)	12IN / 12OUT (IN – 5-24 VDC, OUT – max 30 VDC, 0,5 ADC)	12IN / 12OUT (IN – 5-24 VDC, OUT – max 30 VDC, 0,5 ADC)	12IN / 12OUT (IN – 5-24 VDC, OUT – max 30 VDC, 0,5 ADC)
Electrical parameters			
Power supply	100 – 240 V AC 50/60 Hz	100 – 240 V AC 50/60 Hz	100 – 240 V AC 50/60 Hz
Environmental conditions			
Operating temperature	+10 ÷ +40 °C	+10 ÷ +40 °C	+10 ÷ +40 °C
Relative humidity	40% ÷ 80%	40% ÷ 80%	40% ÷ 80%

* Wi-Fi® is a registered trademark of Wi-Fi® Alliance.



Accessories

RS 232 cables (scale - ZEBRA printer)
 RS 232 cables (scale - printer)
 Barcode scanners
 Displays
 RS 232 cables (scale - Ethernet)
 Label Printers

RS 232, RS 485 cables
 Keypad, external switches
 USB cable (scale - printer)
 RS 232 – USB Converter
 IN/OUT Cables

Software

E2R System
 Audit Trail Reader
 Label Editor R02
 R-LAB
 R.Barcode

RAD-KEY
 LabVIEW Driver
 RADWAG Remote Desktop
 RADWAG Development Studio

Device dimensions

HY10.150.1.HRP.H High Resolution Scale, HY10.1100.HRP.H High Resolution Scale, HY10.600.HRP.H High Resolution Scale

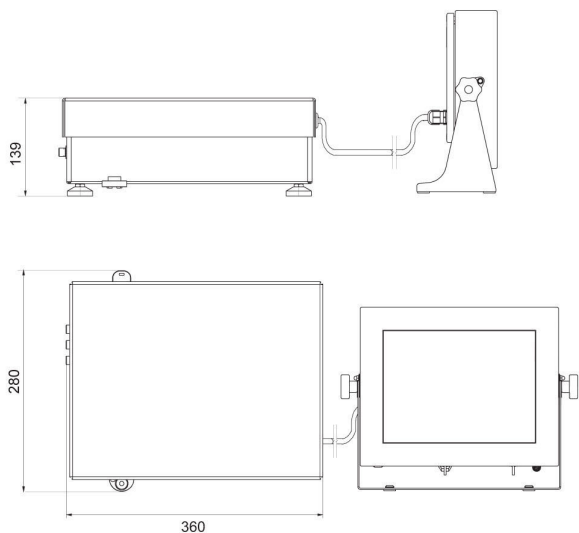

HY10.16 - 32.HRP.H

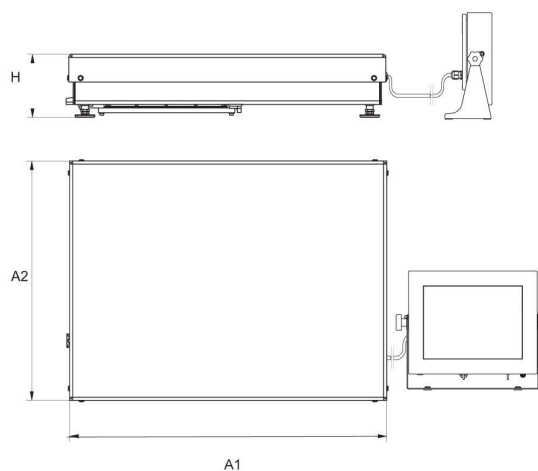

HY10.HRP.H

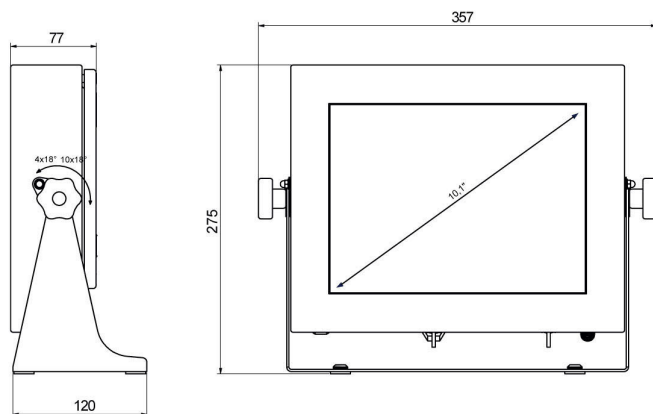

PUE HY10

Scale type	A1	A2	H
HY10.16 - 32.HRP	360	280	145 ± 5
HY10.62 - 120.HRP	500	400	158 ± 5
HY10.150 - 300.HRP	800	600	160 ± 5
HY10.300.1 - 1100.HRP	1000	800	186 ± 5
HY10.2000.HRP	1250	1000	247 ± 5

dimensions in mm